



# SINGLEPASS CURL

User Guide

1.25" curling Iron

Model No. 76550, 76551, 76552, 76553, 76554, 76555, 76556,  
76557, 76558, 76559

# IMPORTANT SAFETY INSTRUCTIONS

## READ ALL INSTRUCTIONS BEFORE USING

When using electrical appliances, especially when children are present, basic safety precautions should always be followed, including the following:



**DANGER**

## KEEP AWAY FROM WATER

Electricity and water are a dangerous combination and can cause death by electric shock. Do not allow electrical cords to come into contact with water or other liquids.

## ELECTRICAL APPLIANCES ARE ELECTRICALLY LIVE WHEN PLUGGED IN, EVEN IF TURNED OFF.

### To reduce the risk of death by electric shock:

1. Always unplug the appliance immediately after using.
2. Do not use while bathing.
3. Do not place or store the appliance where it can fall or be pulled into a bath tub or sink.
4. Do not place in or drop into water or other liquid.
5. If the appliance falls into water, unplug it immediately. Do not reach into the water.

# IMPORTANT SAFETY INSTRUCTIONS



## WARNING

### **To reduce the risk of burns, electrocution, fire or injury to persons:**

1. An appliance should never be left unattended when plugged in.
2. Close supervision is necessary when this appliance is used on, or near children or individuals with certain disabilities.
3. Use this appliance only for its intended use as described in this manual. Do not use attachments not recommended by the manufacturer.
4. Never operate this appliance if it has a damaged cord or plug, if it is not working properly, or if it has been dropped, damaged, or dropped into water. Return the appliance to a service center for examination and repair.
5. Keep the cord away from heated surfaces. Do not wrap the cord around the appliance.
6. Never use while sleeping.
7. Never drop or insert any object into any opening or hose.
8. Do not use outdoors or operate where aerosol (spray) products are being used or where oxygen is being administered.
9. Do not use an extension cord with this appliance.
10. This styling tool is hot when in use. Do not let eyes and bare skin touch heated surfaces.

# IMPORTANT SAFETY INSTRUCTIONS



## WARNING

11. Do not place the heated styling tool directly on any surface while it is hot or plugged in. Use the attached stand.
12. Before plugging in, read the information about world voltage contained in the **Operating Instructions** section of this manual.



Do not use the appliance near a bath tub, washbasin or other vessel filled with water. Never place the appliance in water or any other liquid.

## SAVE THESE INSTRUCTIONS

# MAINTENANCE INSTRUCTIONS

## SINGLEPASS CURL

1. Your appliance is virtually maintenance free. It contains no user serviceable parts and no lubrication is needed.
2. Keep heated surface clean and free of dust, dirt and hairspray.
3. If cleaning becomes necessary, disconnect the appliance from the power source and let it cool. Wipe the exterior with a damp cloth.
4. If any malfunction occurs, unplug the appliance, allow it to cool and return it to a service center for repair.
5. Allow the appliance to cool, and store it in a safe, dry location.
6. Never wrap the cord around the appliance since this will cause the cord to wear prematurely and break. Store the cord loosely coiled. If the cord becomes twisted, untwist it prior to use.
7. Handle the cord carefully for longer life and do not put any stress on the cord where it enters the handle. Avoid jerking, twisting or straining, especially at the plug connections. This could cause the cord to fray and possibly break.
8. Do not attempt to repair the appliance yourself.

### STORAGE

When not in use, your styling tool should be disconnected and stored in a safe, dry location, out of the reach of children. Do not wrap the cord around the styling tool. Allow the cord to hang or lie loose and straight at the point of entry into the styling tool.

# MAINTENANCE INSTRUCTIONS

## SINGLEPASS CURL

### SERVICING OF DOUBLE-INSULATED APPLIANCES

In a double-insulated appliance, two systems of insulation are provided instead of earthing. No earthing means is provided on a double-insulated appliance, nor should a means for earthing be added to the appliance.

Servicing a double-insulated appliance requires extreme care and knowledge of the system, and should be done only by qualified service personnel.

Replacement parts for double-insulated appliances must be identical to the parts they replace. A double-insulated appliance is marked with the words “DOUBLE INSULATION” or “DOUBLE INSULATED”. The symbol (square within a square) may also be marked on the appliance.

# OPERATING INSTRUCTIONS

SINGLEPASS CURL

**This appliance is intended for household use.**

**Use on Alternating Current (50/60 Hz).**

This appliance has a polarized plug (one blade is wider than the other). As a safety feature, this plug will fit in a polarized outlet only one way. If the plug does not fit fully into the outlet, reverse the plug. If it still does not fit, contact a qualified electrician. Do not attempt to defeat this safety feature.



## WARNING

- Do not let the heated curling barrel touch your skin as you may get burnt.



## CAUTION

- Make sure to remove the plug from the outlet after use.
- Do not use if the plug is loose in the outlet as there may be risk of fire, electric shock, electrical shortage and burning.

# OPERATING INSTRUCTIONS

## SINGLEPASS CURL

### **AUTO SHUT-OFF**

After approximately one hour, the unit will automatically shut itself off. To reactivate the unit, turn the Power & Temperature switch once to the right.

### **AUTO WORLD VOLTAGE**

This appliance contains a special electronic circuit that automatically converts it for worldwide usage- from 100 to 240 volts AC 50/60 Hz. Just plug it into the local outlet and use it as normal; the styler will automatically adjust to the local current. You may need an adapter to allow the plug to fit into the local outlets, however.

For connection to a 240-volt supply, use an attachment plug adapter of the proper configuration for the power supply receptacle.



# OPERATING INSTRUCTIONS

## SINGLEPASS CURL

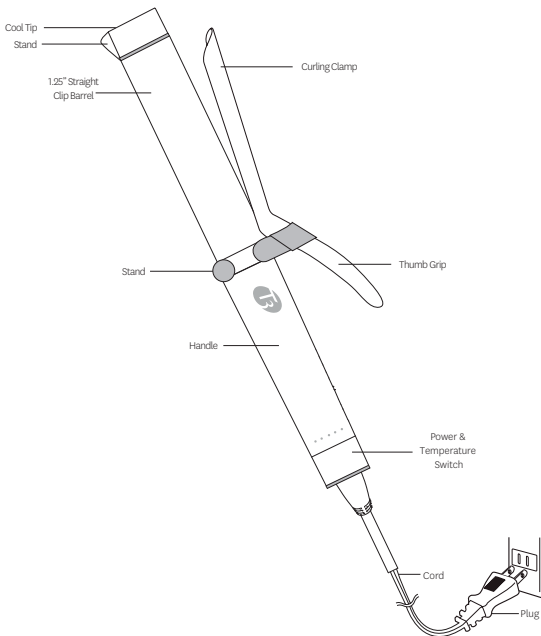

### Temperature Guide

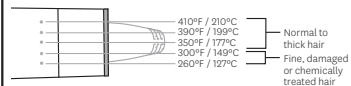

# OPERATING INSTRUCTIONS

## SINGLEPASS CURL

- 1 Turn the Power & Temperature Switch to the right once to turn the tool on. Lights will cascade, then turn solid when the unit is ready to use.

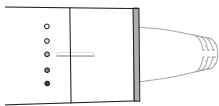

To turn the tool off, turn the Power & Temperature Switch to the right and hold for 2 seconds. The lights will cascade to the left and turn off.

- 2 To change the temperature\*, turn the Power & Temperature Switch to the right again. Continue to turn the switch to cycle through the temperature settings.

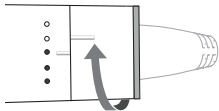

- 3 Release the Power & Temperature Switch after reaching your desired temperature. The selected temperature light(s) will blink, and lights will cascade left or right to your selected temperature. Wait for the lights to turn solid before using the tool.

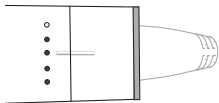

**NOTE:** Each time you turn on this styling tool, it will heat up to your last set temperature.

\* See temperature Guide in Operating Instructions for recommended settings.

# HOW TO USE YOUR

## SINGLEPASS CURL

- 1 Always begin with dry hair. Insert the tip of a 1-2" section of hair into the clamp and roll the iron upwards toward the scalp.



- 2 While rolling, make sure the hair does not overlap itself around the barrel. The entire section of hair must be evenly wrapped around the barrel.

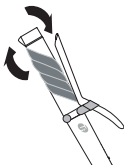

- 3 Hold the iron until the heat has fully penetrated the hair section. Then carefully open the clamp and release the curl.



- 4 Repeat this for the remaining sections of hair. For a loose wavy curl, tug slightly on the curled section before allowing it to cool.



## T3 LIMITED WARRANTY TERMS & CONDITIONS

T3 Micro will repair or replace (at our option) T3 products for twenty-four (24) months from the date of purchase if they are defective in workmanship or materials. This limited warranty does not cover (1) damage due to misuse or abuse, such as incorrect voltage supply, dropping, or failure to follow enclosed instructions or (2) tampering, such as repair or attempt to repair. To obtain service under this warranty, please visit [t3micro.com/warrantyclaim](http://t3micro.com/warrantyclaim) to submit a warranty claim, or call us at (866) 376-8880 to receive detailed instructions. You will be required to provide proof of purchase.

THIS LIMITED WARRANTY IS ONLY VALID IF THE PRODUCT IS PURCHASED FROM AN AUTHORIZED SELLER OF T3 GOODS AND IF THE ORIGINAL SERIAL NUMBER ON THE PRODUCT HAS NOT BEEN REMOVED OR OTHERWISE TAMPERED WITH.

Any implied warranties, obligations, or liabilities, including but not limited to the implied warranty of merchantability and fitness for a particular purpose, shall be limited in duration to the 24 month duration of this written limited warranty. Some states do not allow a limitation on how long an implied warranty lasts, so the above limitation may not apply to you.

IN NO EVENT SHALL T3 BE LIABLE FOR ANY SPECIAL, INCIDENTAL, OR CONSEQUENTIAL DAMAGES FOR BREACH OF THIS OR ANY OTHER WARRANTY, EXPRESS OR IMPLIED.

**Visit [www.T3micro.com/register](http://www.T3micro.com/register) to complete your warranty registration.**

MODEL NO.

76550, 76551, 76552, 76553, 76554, 76555, 76556,  
76557, 76558, 76559

SPECIFICATIONS

Operating Voltage: 100-240V

Power Consumption: 65W

T3 Micro, Inc.  
Venice, CA USA  
Made in China



**WARNING**

Do not use the appliance near a bath tub, washbasin or other vessel filled with water. Never place the appliance in water or any other liquid.

